



Riverside Office: 4080 Lemon Street, 10th Floor, Riverside CA 92501 Ph. (951) 955-4777 Fax (951) 955-4886
Palm Desert Office: 77.933 Las Montanas Rd.# 201 Palm Desert, CA 92211-4131 Ph. (760) 863-8886 (760) 863-7072

Hydrant Verification for Parcel Map Single Family Residential

Note: Some parcel maps will have more stringent requirements on hydrant locations. Check your Environmental Constraint Sheets (ECS map at the Surveyor's Office).

Provide the application number for building/installation/site preparation permit from the Building and Safety Department on all plans, documents, and correspondence. Without the permit number, we cannot process the permit. All of the following shall be submitted to the Riverside County Fire Department for review and approval prior to any releases.

Provide the following letter(s) and map(s):

1. A map or Assessor's Parcel Number (APN) page showing the location of the fire hydrant and access roadway(s) to the property.
2. Written verification from the local water district shall be required indicating the ability to provide the following:
 - a. An approved standard fire hydrant (6"x4"x2½") shall be located within 250 feet from any portion of the lot frontage.
 - b. The minimum fire flow shall be 1000 gpm at 20 psi residual pressure for a 2-hour duration.
 - c. Water district must also indicate the size of the water main serving the fire hydrant.

Only original documents will be accepted. Copies and faxes of the letter and map will not be accepted.



Standard Hydrant
(Wet Barrel)



Super Hydrant
(Wet Barrel)



Super Hydrant
(Dry Barrel)



Riverside Office: 2300 Market St., Ste. 150, Riverside, CA 92501 Ph. (951) 955-4777 Fax (951) 955-4886
~~Murrieta Office: 89499 Los Alamitos Rd., Ste. A, Murrieta, CA 92563 Ph. (951) 690-6160 Fax (951) 690-6164~~
 Palm Desert Office: 77-933 Las Montañas Rd., # 201 Palm Desert, CA 92211-4131 Ph. (760) 863-8886 (760) 863-7072

Information Bulletin

Date Issued:		Revision Date: 6/17/08	IB # 06-06
Topic:	Conditions for the Mountainous and High Fire Hazard Areas of Riverside County		
Code Section:	Riverside County Ordinance 787.3		
Author: Committee	Date:	Approved: T. Hobday, FM	Date:
Sign:		Sign:	

The Riverside County Fire Department Fire Protection Planning Section (RCFD FPPS) will apply the following requirements for mountainous, high fire hazard areas of Riverside County. To assist in the preparation and submittal of required plans, the following minimum information shall be provided. Additional information may be required on a case-by-case basis as determined by the plan reviewer.

- 1) Access Roads:
 - a) Driveways less than 150-feet in length with a minimum width of 12-feet, no turnouts or turnarounds are required.
 - b) Driveways exceeding 150-feet, but less than 300-feet in length, shall be provided with a minimum width of 16-feet and an approved turnout at mid-point. An approved turnaround shall be provided within 50-feet of any building.
 - c) If a required turnout cannot be provided at mid-point, the minimum road width shall be 20-feet the entire length with a turnaround within 50-feet of any building.
 - d) Driveways exceeding 300-feet shall be no less than 20-feet in width. No turnouts are required, however, an approved turnaround shall be provided within 50-feet of any building.
 - e) Multiple parcels served by the same access shall be a minimum of 20-feet in width regardless of driveway length.
 - f) Turnaround areas shall be approved by the Fire Department for location and size.
 - g) Access roads shall not have an up or down grade in excess of 15%.

- 2) Water for Fire Protection:
 - a) If within a water-serving district, an approved fire hydrant shall be located within 250 feet of any portion of the lot frontage with a minimum fire flow of 1000 gallons per minute. The local Water Purveyor shall provide system information.
 - b) If no water system exists, a tank sufficient to contain 2-gallons per square foot of the largest structure shall be provided on site. Minimum tank size for fire protection is 2,500 gallons.
 - c) On-site water tank plans shall be reviewed and approved by the Fire Department for size, construction and location.
 - d) In lieu of on-site water storage in excess of 2,500 gallons, a sprinkler system in compliance with NFPA 13D standards may be used as mitigation. The system shall be designed by a properly licensed fire protection contractor (C-16), submitted for review and approval by the Fire Department prior to installation. With the NFPA 13D system the on-site storage requirement may be reduced to not less than 2,500 gallons.

- 3) Fuel Modification, Removal of Flammable/Combustible Materials:
 - a) Buildings in high fire areas shall provide a minimum 100-foot clearance, or as may be otherwise approved by the Fire Department, of all flammable/combustible vegetation and/or materials from all buildings.
 - b) Special construction measures may be required.

Questions regarding specific applications should be directed to RCoFD Fire Protection Planning staff.

RIVERSIDE COUNTY FIRE DEPARTMENT
FIRE PROTECTION PLANNING AND ENGINEERING SECTION

FIRE APPARATUS TURNAROUND STANDARD FOR ENGINES

(IN AREAS WHERE AERIAL LADDER SERVICE ACCESS IS DETERMINED TO BE NOT NEEDED BY THE FIRE DEPARTMENT)

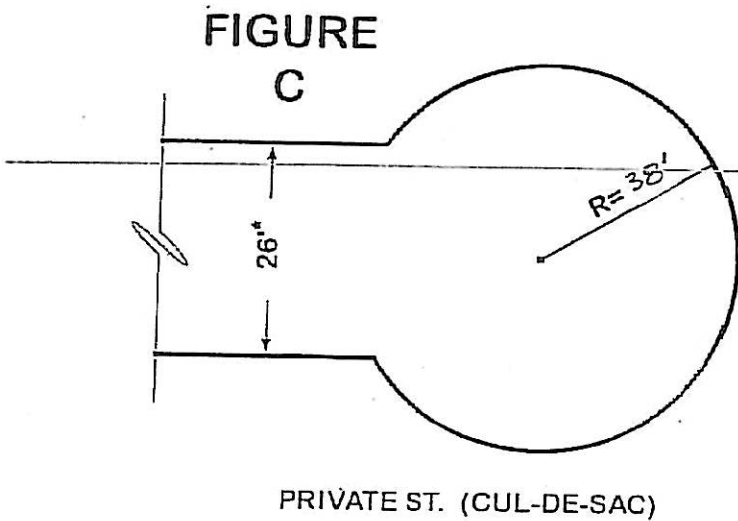
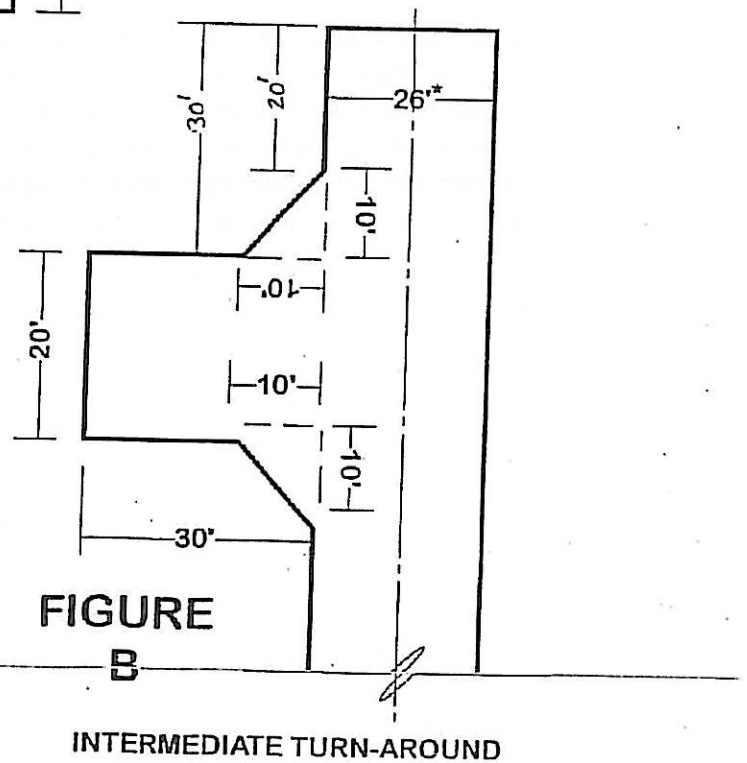
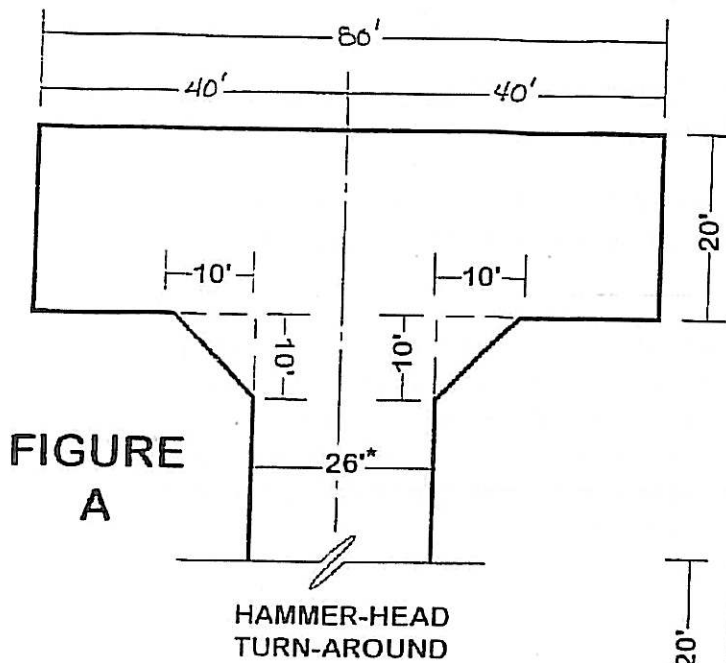

* Entering driveway area may be reduced to 20' when servicing only one single-family dwelling